

LUFFING JIB TOWER CRANE

# RTL 265-18

HP20<sub>II / III / IV FALLS</sub>

TECHNICAL DATA SHEET



**RECOM**<sup>TM</sup>  
Moritsch



알엠디인터내셔널(주)

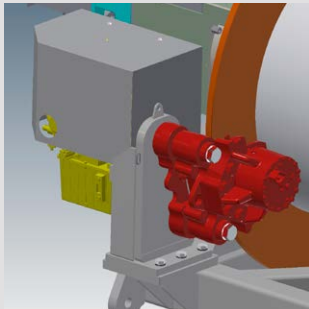

## NEW STROMAG SAFETY BRAKE ON HOIST DRUM

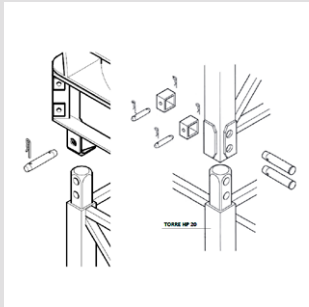

## TOWER TYPE HP 20

The famous boxed beams -twin pins connections. Safety and performances trough pins.



## CABIN

New design CAB , wider, longer, with improved visibility. Grammer seat and gessman joy-stick for driver cofort and ABB controls for maximum safety. USB door, air con, easy cleaning of windows, 10" or 6" screen included.

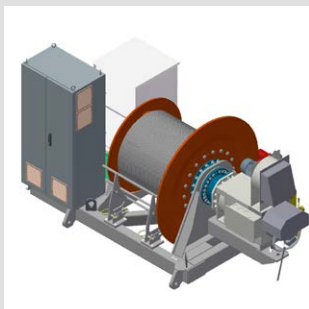

## WINCHES

New generation of high power winches, from 67 to 110 kw. New braking system, new reduction gear to grant highest performances ever seen on a luffer.

# RTL 265-18

## HP20 II / III / IV FALLS

TECHNICAL DATA SHEET

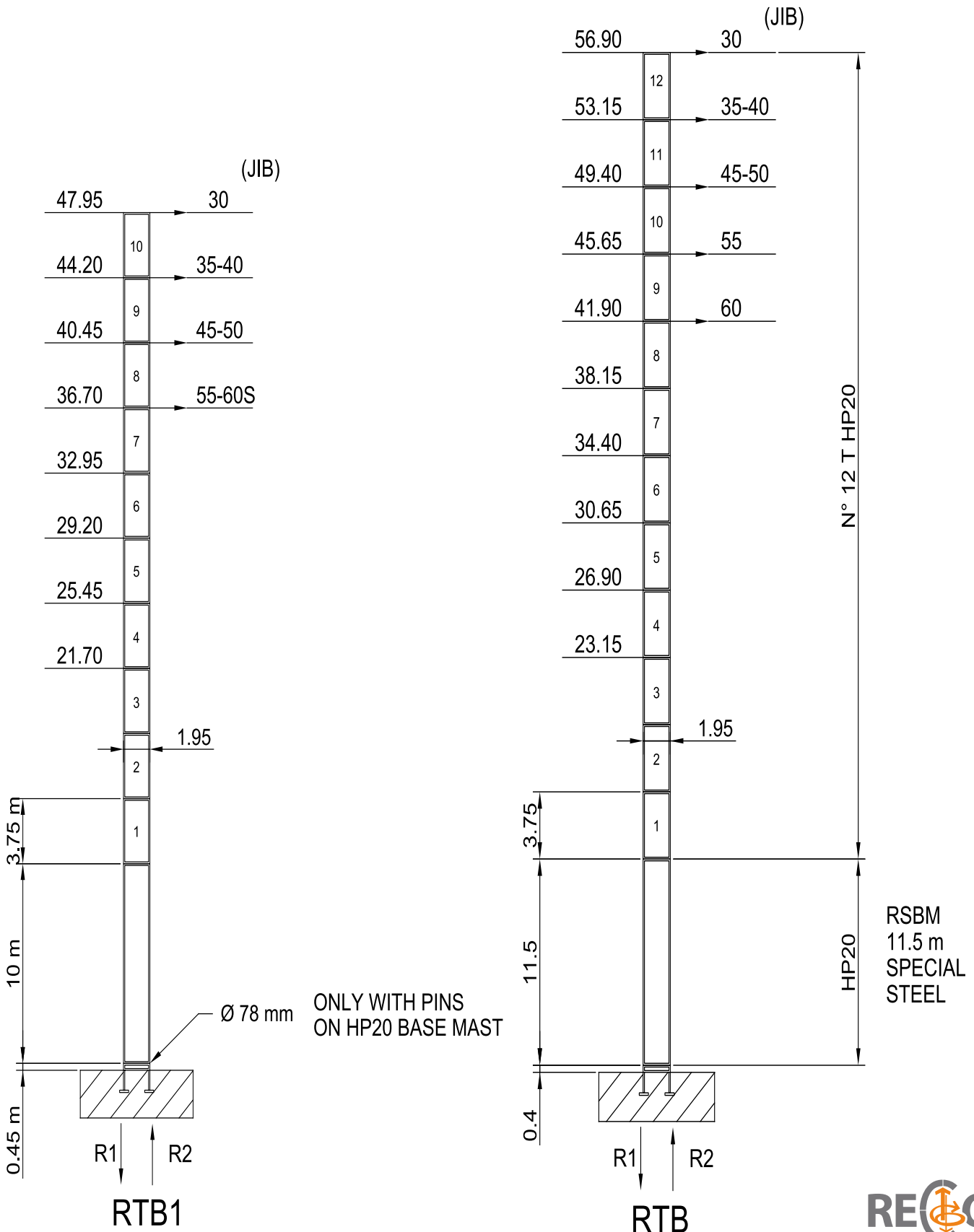



EXTERNAL CLIMBING JIB 35-40

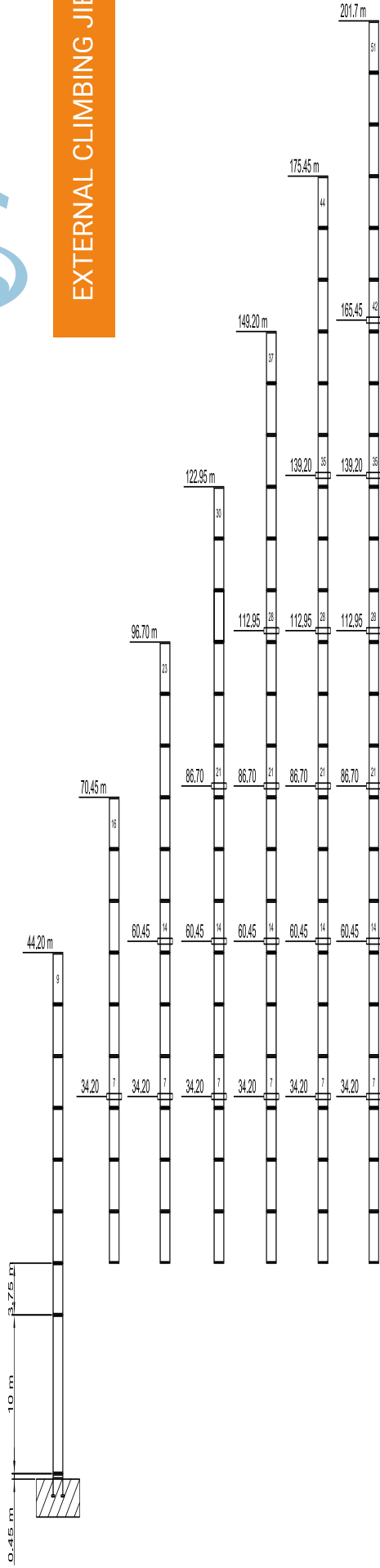

EXTERNAL CLIMBING JIB 45-50

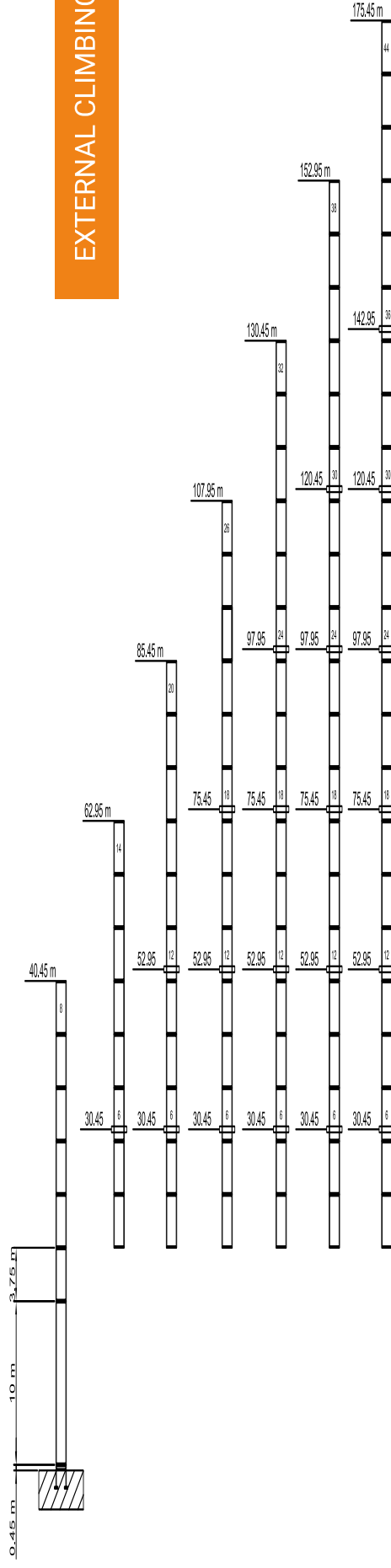

EXTERNAL CLIMBING JIB 55-60

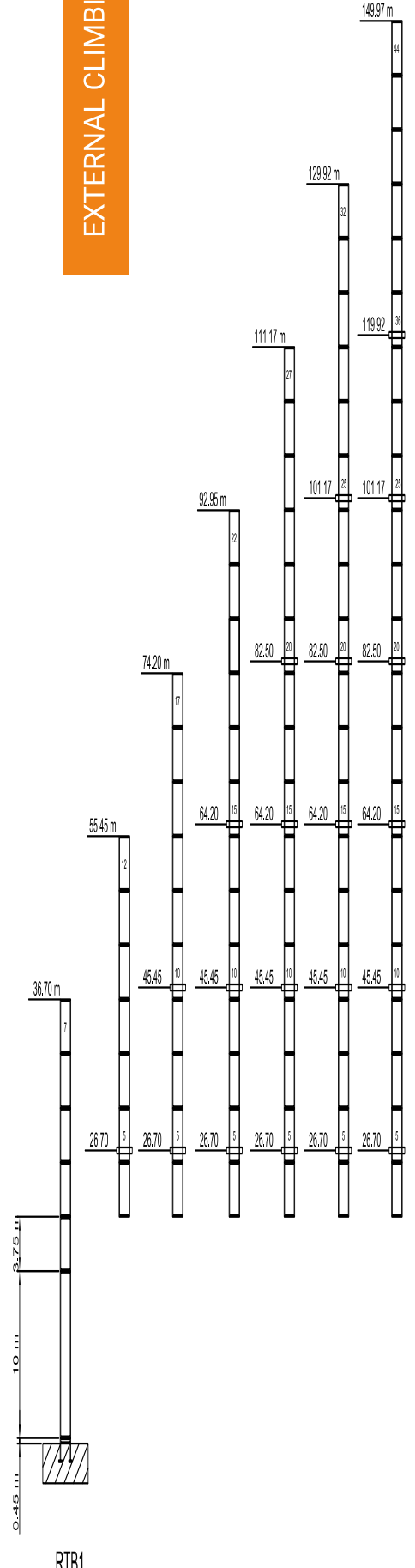





67 HVF 90

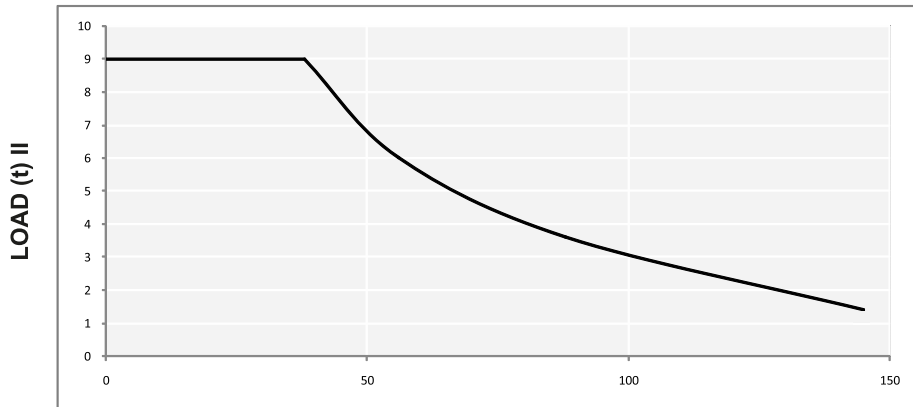

HOISTING

		t	m/min		kW		
	67 HVF 90	II	9	0	→	38	
			6	0	→	56	
			3,6	0	→	88	
			1,4	0	→	145	
		III	13,5	0	→	25	
			9	0	→	37	
			5,4	0	→	58	
			2,1	0	→	96	
		IV	18	0	→	19	
			12	0	→	28	
			7,2	0	→	44	
			2,8	0	→	72	



Hoisting Winch 67 kW

Max rope on drum: 970 (1150 optional)



Luffing Winch 67 kW

15° → 85° = 1.8 min.



Slewing 2 x 10.8 kW

0.75 rpm.

## PACKING LIST

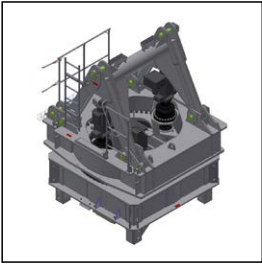

**SLEWING RING  
SUPPORT HP20  
+ UPPER SLEWING RING  
SUPPORT A-FRAME**  
quantity: 1  
width: 2,35 m  
length: 2,59 m  
height: 3,36 m  
weight: 10800 kg

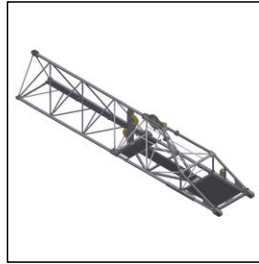

**JIB SECTION 1B**  
quantity: 1  
width: 1,76 m  
length: 10,56 m  
height: 1,76 m  
weight: 2140 kg



**SLEW. RING SUPPORT  
+ CAB PLATFORM  
+ CAB + F.M.B ASSEMBLY**  
quantity: 1  
width: 1,95 m  
length: 4,65 m  
height: 2,25 m  
weight: 2200 kg

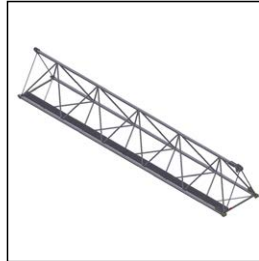

**JIB SECTION 2**  
quantity: 1  
width: 1,76 m  
length: 10,53 m  
height: 1,76 m  
weight: 1340 kg



**COUNTERJIB  
+ PLATFORMS  
+ COUNTERJIB  
+ PLATFORMS  
+ RETAINER FRAME**  
quantity: 1  
width: 4,76 m  
length: 7,60 m  
height: 2,01 m  
weight: 7000 kg

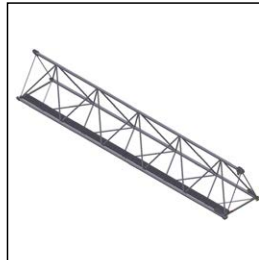

**JIB SECTION 3**  
quantity: 2  
width: 1,76 m  
length: 10,53 m  
height: 1,76 m  
weight: 1150 kg

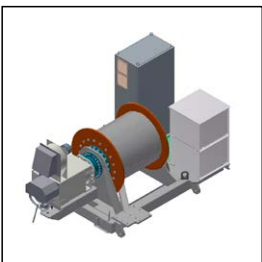

**HOISTING WINCH  
67 HVF90-F16 R00  
67 kW  
(Complete with rope 970m)**  
quantity: 1  
width: 1,94 m  
length: 3,38 m  
height: 1,91 m  
weight: 5350 kg



**JIB SECTION 4**  
quantity: 2  
width: 1,76 m  
length: 5,35 m  
height: 1,76 m  
weight: 580 kg

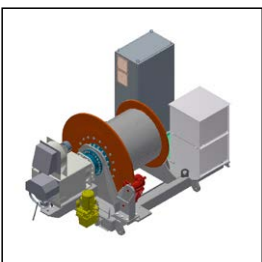

**HOISTING WINCH  
67 HVF90-F16 R01  
67 kW  
(Complete with rope 970m)**  
quantity: 1  
width: 1,94 m  
length: 3,38 m  
height: 1,91 m  
weight: 5750 kg

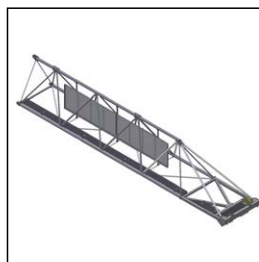

**JIB SECTION 5B**  
quantity: 1  
width: 1,76 m  
length: 10,60 m  
height: 1,76 m  
weight: 1370 kg

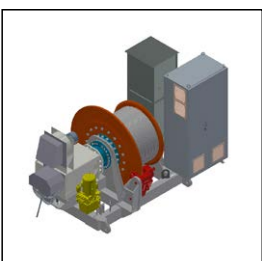

**LUFFING WINCH  
LVF67-F16  
67 kW  
(Complete with rope 290m)**  
quantity: 1  
width: 1,70 m  
length: 3,05 m  
height: 1,87 m  
weight: 4350 kg



**A-FRAME UNIT  
(A-FRAME HEAD  
+ A-FRAME MAIN FRAME  
+ A-FRAME TIE-BAR  
+ PLATFORM A and B A-FRAME  
LADDERS  
+ SECTION DIVIDER  
+ MOBILE SHEAVE  
+ JIB EXPELLER)**

quantity: 1  
width: 2,46 m  
length: 7,15 m  
height: 12,90 m  
weight: 6000 kg

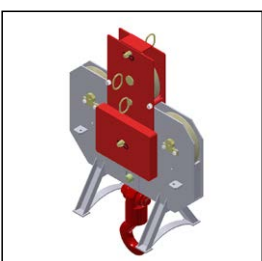

**FALL HOIST BLOCK**  
quantity: 1  
width: 0,52 m  
length: 1,19 m  
height: 1,75 m  
weight: 720 kg





**RECOM S.R.L.**

via Vittorio Veneto 158/b  
32100 Belluno | BL | Italy  
T. +39 0437 1840396  
info@recomcranes.it  
www.recomcranes.it

**-레콤크레인 한국독점딜러-**



알엠디인터내셔널(주)

T. 02 415 5238

F. 02 400 6617

E. rmdi@daum.net

서울시 송파구 오금로 87, 2122호(방이동, 잠실리시온)